

RoHS Compliant

Rev.	change details	effective date	updated by	date
A	Initial release	2020.12.19	FHY	20.12.19

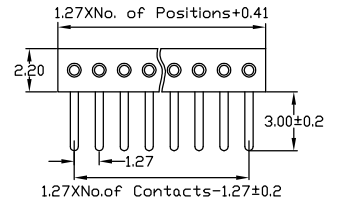

Right socket connector:solder tail single row
Availability from:2 to 50 contacts
Standard number of contacts 25 and 50

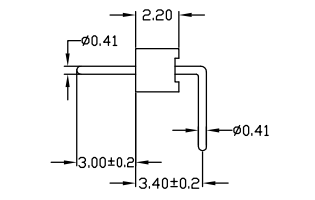
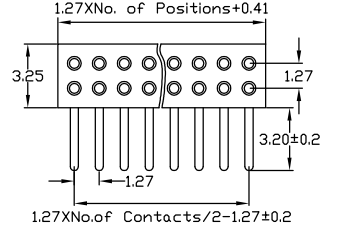
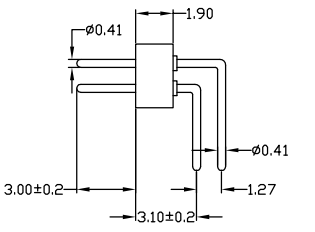

Right socket connector:solder tail double row
Availability from:4 to 100 contacts
Standard number of contacts 50 and 100

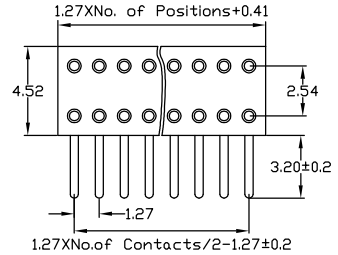
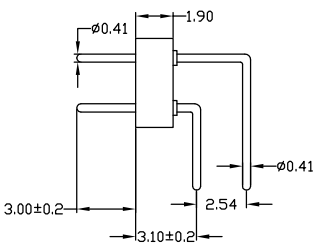

Right socket connector:solder tail double row with 2.54mm row to row distance
Availability from:4 to 100 contacts
Standard number of contacts 100

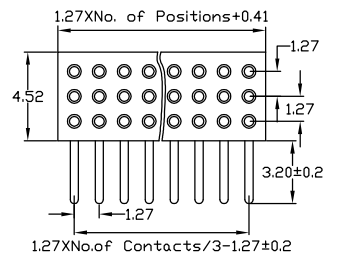
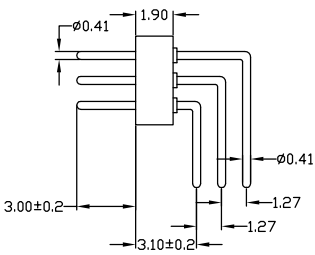

Right socket connector:solder tail triple row
Availability from:6 to 150 contacts
Standard number of contacts 150

Std. Material
Insulator :Black glass filled polyester
PPS-GF30-FR
Flammability : UL94V-0
Sleeve : Brass CuZn 36Pb3(36000)
Mating pin Ø : 0.41 mm
Mechanical life : min 500 cycles
Rated current : 1Amp
Contact resistance: Max 10mΩ
Dielectric resistance : Min 1000V_{RMS}

Temperature
Operating Temp.: -40°C to 105°C
Max. Processing Temp.: 260°C for 10s
Packing : PE bag or agree on_____

Ordering Information

No. of Pins	Contact Plating	Insulator Material
Rows*Pins	SN: Tin <input type="checkbox"/>	A: PBT <input type="checkbox"/>
1/2/3 x 50	G0: 0.8u" Gold <input type="checkbox"/>	B: PA6T <input type="checkbox"/>
	G1: 1u" Gold <input type="checkbox"/>	C: PA9T <input type="checkbox"/>
Ordering:(N)	G2: 1.5u" Gold <input type="checkbox"/>	D: PA66 <input type="checkbox"/>
X <input type="checkbox"/>	G3: 2u" Gold <input type="checkbox"/>	E: PA46 <input type="checkbox"/>
	G4: 3u" Gold <input type="checkbox"/>	F: LCP <input type="checkbox"/>
	G5: ___u" Gold <input type="checkbox"/>	G: _____ <input type="checkbox"/>

Ordering Dimensions

A	B	C	D	H	W
PA	PB	PC	PD	PW	L

Remarks:

UNLESS OTHERWISE STATED		ORIGINALLY BY
DIMENSIONS IN mm		DRAWN: FHY
TOLERANCE:		CHECKED: FY
ANGLEAR ±1°	LINEAR	APPROVED: FY
	X 0.5	DATE:2020.12.19
	X.X ±0.2	
	X.XX ±0.1	



深圳市征华电子有限公司
Shenzhen ZWON Electronics Co.,Ltd.



SERIES: Round PH1.27/Right Angle
TYPICAL MODEL: 1.27 圆孔 排针 90度

Drawing No.	DRXXX-XX	
Scale	Revision	Sheet
FIT	A	1 of 1
ZWON P/N:		
Customer P/N:		