

RoHS Compliant

Rev.	change details	effective date	updated by	date
A	Initial release	2020.12.19	FHY	20.12.19

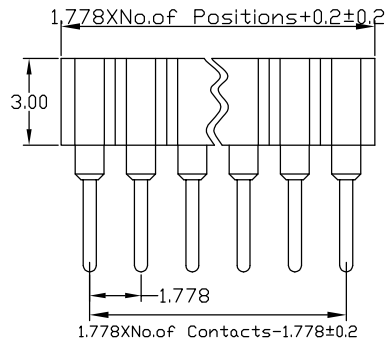

Straight socket connector:single row
grid spacing 1.778mm
Availability from:2 to 32 contacts
Standard number of contacts 21 and 32

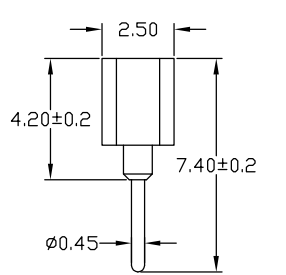
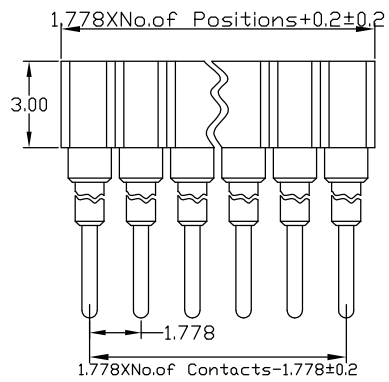
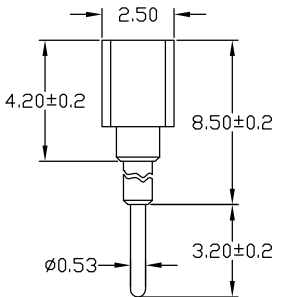

Straight socket connector elevated:
single row grid spacing 1.778mm
Availability from:2 to 32 contacts
Standard number of contacts 21 and 32

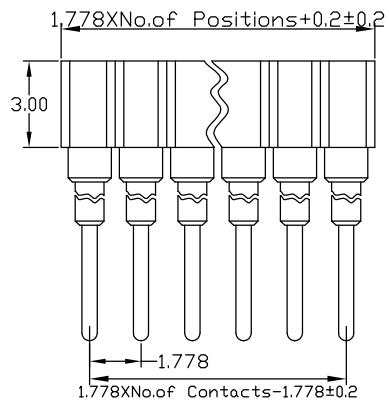
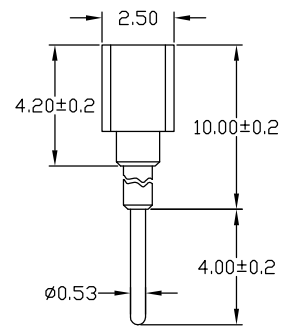

Straight socket connector:single row
grid spacing 1.778mm
Availability from:2 to 32 contacts
Standard number of contacts 32

Std. Material
Insulator:Black glass filled polyester
PPS-GF30-FR
Flammability : UL94V-0
Sleeve : Brass CuZn 36Pb3(36000)
Contact cilp (6 finger):Beryllium copper (C17200)
Mating pin ϕ : 0.40 to 0.56 mm
Forces : (polished steel gauge ϕ 0.46mm)
-Insertion : 2 N typ.
-Withdrawal : 1N typ.
Mechanical life : min 500 cycles
Rated current : 1Amp
Contact resistance: Max 10m Ω
Dielectric resistance : Min 1000V RMS

Temperature
Operating Temp. : -40 $^{\circ}$ C to 105 $^{\circ}$ C
Max. Processing Temp.: 260 $^{\circ}$ C for 10s
Packing : PE bag or agree on_____

Ordering Information

No. of Pins	Contact Plating	Insulator Material
Rows*Pins 1 x 50	SN: Tin <input type="checkbox"/> G0: 0.8u" Gold <input type="checkbox"/> G1: 1u" Gold <input type="checkbox"/> G2: 1.5u" Gold <input type="checkbox"/> G3: 2u" Gold <input type="checkbox"/> G4: 3u" Gold <input type="checkbox"/> G5: ___u" Gold <input type="checkbox"/>	A: PBT <input type="checkbox"/> B: PA6T <input type="checkbox"/> C: PA9T <input type="checkbox"/> D: PA66 <input type="checkbox"/> E: PA46 <input type="checkbox"/> F: LCP <input type="checkbox"/> G: _____ <input type="checkbox"/>

Ordering Dimensions

A	B	C	D	H	W
PA	PB	PC	PD	PW	L

Remarks:

UNLESS OTHERWISE STATED	ORIGINALLY BY
DIMENSIONS IN mm	DRAWN: FHY
TOLERANCE:	CHECKED: FY
	APPROVED: FY
	DATE:2020.12.19
ANGLEAR $\pm 1^{\circ}$	LINEAR X 0.5 X.X ± 0.2 X.XX ± 0.1



深圳市征华电子有限公司
Shenzhen ZWON Electronics Co.,Ltd.
S SERIES: Round FH1.778*3.0/Straight
TYPICAL MODEL: 1.778单排 圆孔排母 塑高3.0 180度

Drawing No.	DRXXX-XX
Scale	Revision
FIT	A
Sheet	1 of 1
ZWON P/N:	
Customer P/N:	