

RoHS Compliant

Rev.	change details	effective date	updated by	date
A	Initial release	2020.12.19	FHY	20.12.19

See page 33	No.of Positions	A	B	C	D
fig. 1	6	7.6	7.62	10.1	2.54/7.62
fig. 2	8	10.1	7.62	10.1	2.54/7.62
fig. 3	10	12.6	7.62	10.1	2.54/7.62
fig. 4	12	15.2	7.62	10.1	2.54/7.62
fig. 5	14	17.7	7.62	10.1	2.54/7.62
fig. 6	16	20.3	7.62	10.1	2.54/7.62
fig. 7	18	22.8	7.62	10.1	2.54/7.62
fig. 8	20	25.3	7.62	10.1	2.54/7.62
fig. 9	22	27.8	7.62	10.1	2.54/7.62
fig. 10	24	30.4	7.62	10.1	2.54/7.62
fig. 11	28	35.5	7.62	10.1	2.54/7.62

fig. 12	24	30.5	15.24	17.7	2.54/7.62
fig. 13	28	35.5	15.24	17.7	2.54/7.62
fig. 14	32	40.6	15.24	17.7	2.54/7.62
fig. 15	36	45.7	15.24	17.7	2.54/7.62
fig. 16	40	50.8	15.24	17.7	2.54/7.62
fig. 17	42	53.3	15.24	17.7	2.54/7.62
fig. 18	48	60.9	15.24	17.7	2.54/7.62

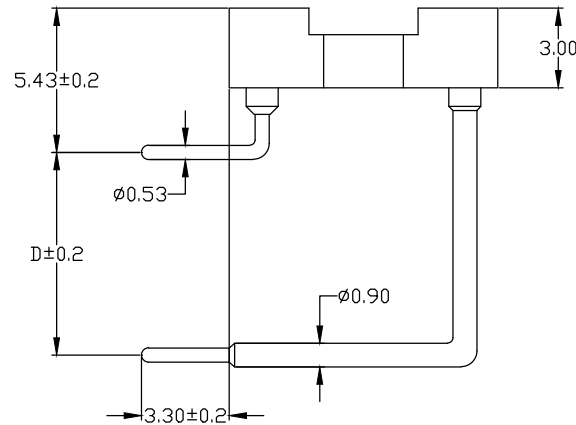
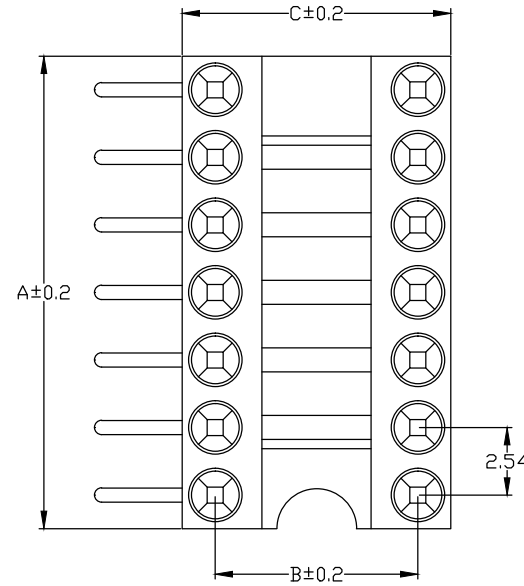

Std. Material
 Insulator : Black glass filled polyester PPS-GF30-FR
 Flammability : UL94V-0
 Sleeve : Brass CuZn 36Pb3(36000)
 Contact clip (4 finger): Beryllium copper (C17200)
 Mating pin ϕ : 0.40 to 0.56mm
 Forces: (polished steel gauge ϕ 0.43mm)
 -Insertion : 2 N typ.
 -Withdrawal: 1 N typ.
 Mechanical life : min 100 cycles
 Rated current : 1Amp
 Contact resistance: Max 10m Ω
 Dielectric resistance : Min 1000V_{RMS} terminations : max 0.1mm

Temperature
 Operating Temp. : -40 $^{\circ}$ C to 105 $^{\circ}$ C
 Max. Processing Temp.: 260 $^{\circ}$ C for 10s
Packing : Tray or agree on _____

Ordering Information

No. of Pins	Contact Plating	Insulator Material
Rows*Pins 2 x 40	SN: Tin <input type="checkbox"/> G0: 0.8u" Gold <input type="checkbox"/> G1: 1u" Gold <input type="checkbox"/> G2: 1.5u" Gold <input type="checkbox"/> G3: 2u" Gold <input type="checkbox"/> G4: 3u" Gold <input type="checkbox"/> G5: __u" Gold <input type="checkbox"/>	A: PBT <input type="checkbox"/> B: PA6T <input type="checkbox"/> C: PA9T <input type="checkbox"/> D: PA66 <input type="checkbox"/> E: PA46 <input type="checkbox"/> F: LCP <input type="checkbox"/> G: _____ <input type="checkbox"/>
Ordering:(N) 2 X <input type="checkbox"/>		

Ordering Dimensions

A	B	C	D	H	W
PA	PB	PC	PD	PW	L

Remarks:

UNLESS OTHERWISE STATED
 DIMENSIONS IN mm
 TOLERANCE:

ANGLEAR $\pm 1^{\circ}$	LINEAR X 0.5 X.X ± 0.2 X.XX ± 0.1
-------------------------	--

ORIGINALLY BY **ZWON**
 DRAWN: FHY
 CHECKED: FY
 APPROVED: FY
 DATE: 2020.12.19

扫码官网 发现更多

深圳市征华电子有限公司
 Shenzhen ZWON Electronics Co.,Ltd.
 SERIES: 2.54 Round IC Socket/Right Angle
 TYPICAL MODEL: 2.54圆孔 IC座 塑高3.0 90度

Drawing No.	DRXXX-XX	
Scale	Revision	Sheet
FIT	A	1 of 1
ZWON P/N:		
Customer P/N:		