

RoHS Compliant

Rev.	change details	effective date	updated by	date
A	Initial release	2020.12.19	FHY	20.12.19

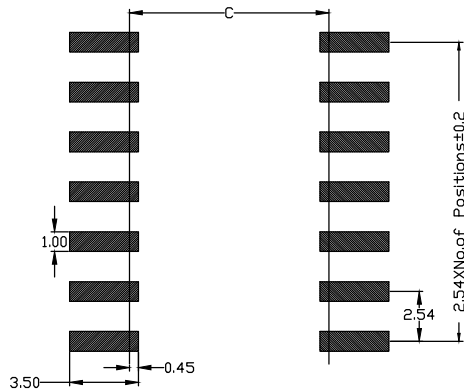
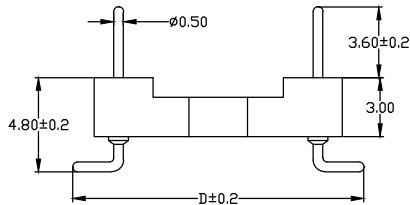
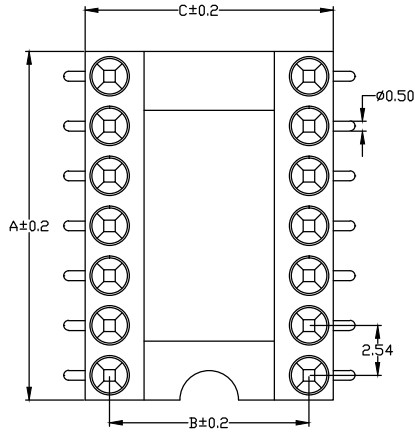

See page 33	No.of Positions	A	B	C	D
fig. 1	6	7.6	7.62	10.1	12.30
fig. 2	8	10.1	7.62	10.1	12.30
fig. 3	10	12.6	7.62	10.1	12.30
fig. 4	12	15.2	7.62	10.1	12.30
fig. 5	14	17.7	7.62	10.1	12.30
fig. 6	16	20.3	7.62	10.1	12.30
fig. 7	18	22.8	7.62	10.1	12.30
fig. 8	20	25.3	7.62	10.1	12.30
fig. 9	22	27.8	7.62	10.1	12.30
fig. 10	24	30.4	7.62	10.1	12.30
fig. 11	28	35.5	7.62	10.1	12.30
fig. 12	20	25.4	10.16	12.6	14.84
fig. 13	22	27.8	10.16	12.6	14.84
fig. 14	24	30.4	10.16	12.6	14.84
fig. 15	28	35.5	10.16	12.6	14.84
fig. 16	32	40.6	10.16	12.6	14.84
fig. 17	24	30.5	15.24	17.7	19.92
fig. 18	28	35.5	15.24	17.7	19.92
fig. 19	32	40.6	15.24	17.7	19.92
fig. 20	36	45.7	15.24	17.7	19.92
fig. 21	40	50.8	15.24	17.7	19.92
fig. 22	42	53.3	15.24	17.7	19.92
fig. 23	48	60.9	15.24	17.7	19.92

Std. Material

Insulator : Black glass filled polyester PPS-GF30-FR
 Flammability : UL94V-0
 Sleeve : Brass CuZn 36Pb3(36000)
 Contact cilp (4 finger): Beryllium copper (C17200)
 Mating pin ϕ : 0.50 mm
 Mechanical life : min 100 cycles
 Rated current : 1Amp
 Contact resistance: Max 10m Ω
 Dielectric resistance : Min 1000V_{RMS}
 Coplanariny SMT terminations : max 0.1mm

Temperature

Operating Temp. : -40 $^{\circ}$ C to 105 $^{\circ}$ C
 Max. Processing Temp.: 260 $^{\circ}$ C for 10s

Packing : Tray or agree on _____

Ordering Information

No. of Pins	Contact Plating	Insulator Material
Rows*Pins 2 x 40	SN: Tin <input type="checkbox"/> G0: 0.8u" Gold <input type="checkbox"/> G1: 1u" Gold <input type="checkbox"/> G2: 1.5u" Gold <input type="checkbox"/> G3: 2u" Gold <input type="checkbox"/> G4: 3u" Gold <input type="checkbox"/> G5: ___u" Gold <input type="checkbox"/>	A: PBT <input type="checkbox"/> B: PA6T <input type="checkbox"/> C: PA9T <input type="checkbox"/> D: PA66 <input type="checkbox"/> E: PA46 <input type="checkbox"/> F: LCP <input type="checkbox"/> G: _____ <input type="checkbox"/>
Ordering:(N) 2 X <input type="checkbox"/>		

Ordering Dimensions

A	B	C	D	H	W
PA	PB	PC	PD	PW	L

Remarks:

UNLESS OTHERWISE STATED DIMENSIONS IN mm TOLERANCE:	ORIGINALLY BY
	DRAWN: FHY
	CHECKED: FY
	APPROVED: FY
	DATE:2020.12.19



深圳市征华电子有限公司
 Shenzhen ZWON Electronics Co.,Ltd.



SERIES: 2.54 Round IC Socket/SMT
 TYPICAL MODEL: 2.54圆孔 IC座 塑高3.0 SMT Type1

Drawing No.	DRXXX-XX	
Scale	Revision	Sheet
FIT	A	1 of 1
ZWON P/N:		
Customer P/N:		