

RoHS Compliant

Rev.	change details	effective date	updated by	date
A	Initial release	2020.12.19	FHY	20.12.19

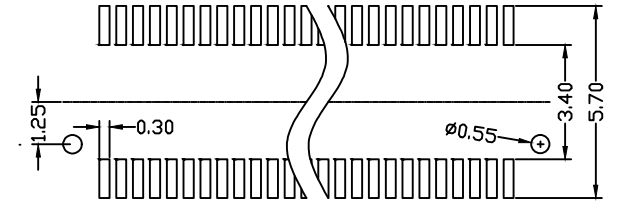

Recommended P.C.B. Layout

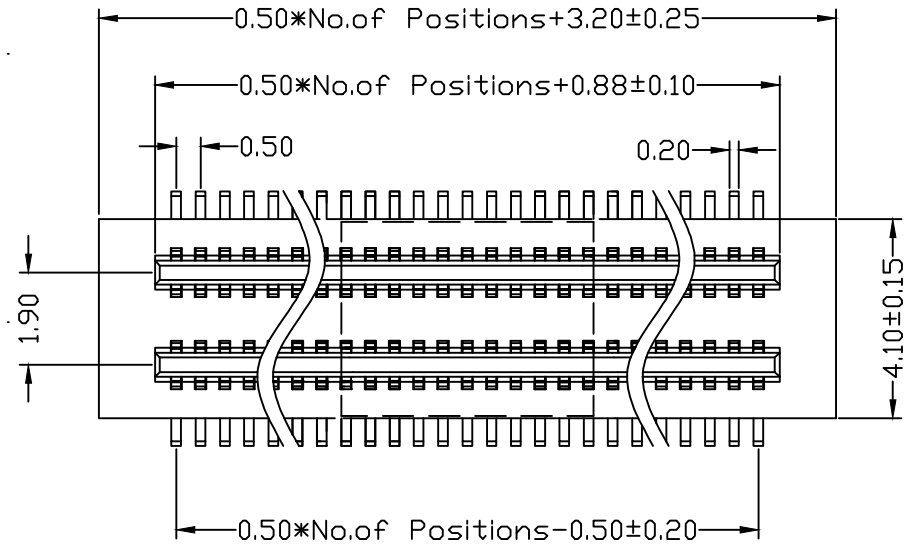
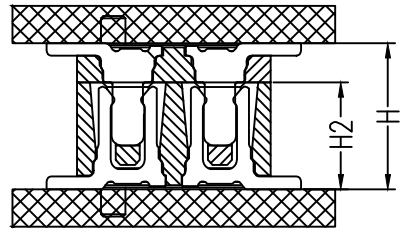

ASS'Y HIGH(H)	PLUG(H1)	SOCKET(H2)
3.00	0.80	2.20
3.50	0.80	2.70
4.00	1.00	3.00
4.50	1.50	3.00
5.00	2.00	3.00
5.50	1.50	4.00
6.00	2.00	4.00

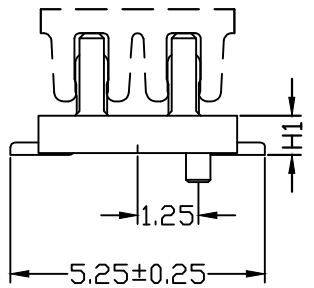
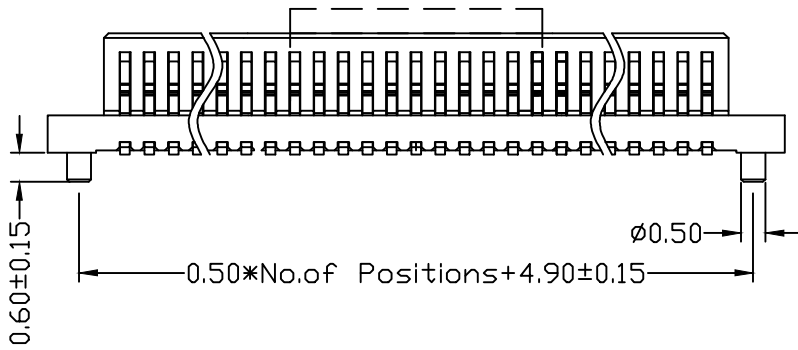

NOTES:  
 Current Rating: 0.5A  
 Voltage Rating: 50V AC/DC  
 Contact Resistance: 50 Milliohm Max  
 Insulation Resistance: 100 Megohm Min  
 Operation Temperature: -20°C to +105°C

Housing Material: PA9T+30%G.F(UL94V-0)  
 Contact Material: Phosphor Bronze  
 Contact Plating: Au or Sn Over Ni

UNLESS OTHERWISE STATED DIMENSIONS IN mm TOLERANCE:	ORIGINALLY BY	 深圳市征华电子有限公司 Shenzhen ZWON Electronics Co.,Ltd.
	DRAWN: FHY	
	CHECKED: FY	
	APPROVED: FY	
DATE: 2020.12.19	扫描官网 发现更多	
ANGLEAR ±1°	LINEAR X 0.5 X.X ±0.2 X.XX ±0.1	

DRAWING No.	DRXXX-XX	
	Scale	Revision
FIT		A
SHEET		1 of 1
SERIES: 0.50 BTB/Male/Dual Slot/SMT		ZWON P/N:
TYPICAL MODEL: 0.50mm BTB 公头 双槽 SMT 带柱		Customer P/N: