

RoHS Compliant

| Rev. | change details | effective date | updated by | date |
|------|-----------------|----------------|------------|----------|
| A | Initial release | 2020.12.19 | FHY | 20.12.19 |

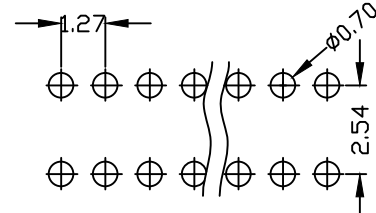

Recommended P.C.B. Layout

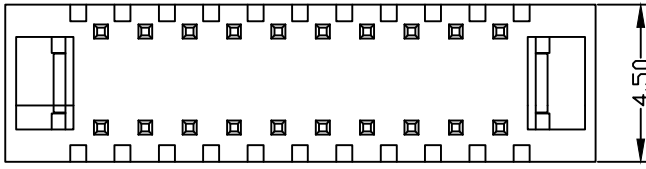
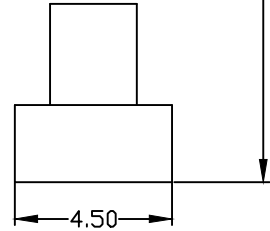
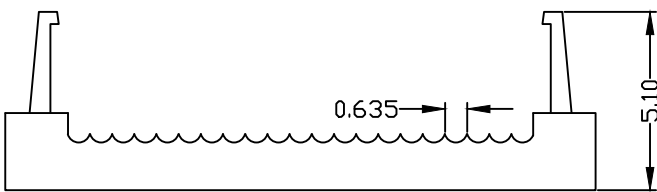
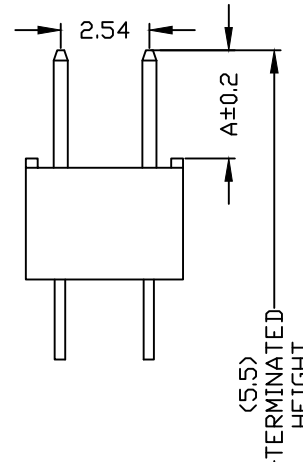
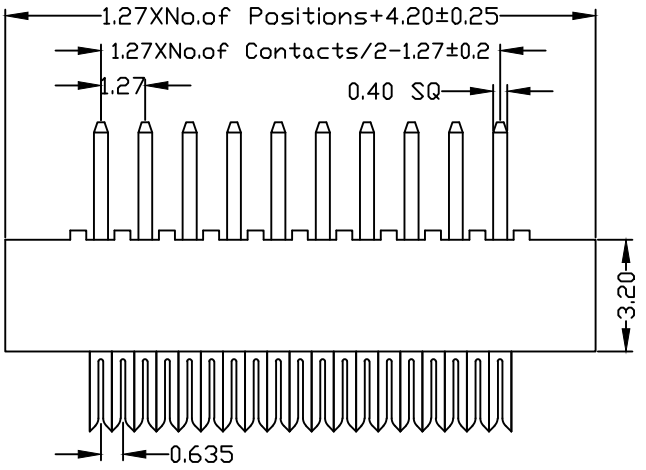

Std. Material
 Contact: Brass
 Contact Plating: 1u" Au over 30u" Ni Min.
 Insulator: PBT(UL94V-0).
 Insulator Colour: Black

Temperature
 Operating Temp.: -40°C to 105°C
 Max. Processing Temp.: 140°C

Electronic Specifications
 Current Rating: 1 AMP
 Contact Resistance: 20mΩ Max.
 Insulation Resistance: 1000MΩ Min.
 Withstanding Voltage: AC 1000V for 60s

Packing: Tray or agree on _____

Ordering Information

| No. of Pins | Contact Plating | Insulator Material |
|--|--|---|
| Rows*Pins 2 x 50 | SN: Tin <input type="checkbox"/> G0: 0.8u" Gold <input type="checkbox"/> G1: 1u" Gold <input type="checkbox"/> G2: 1.5u" Gold <input type="checkbox"/> G3: 2u" Gold <input type="checkbox"/> G4: 3u" Gold <input type="checkbox"/> G5: ___u" Gold <input type="checkbox"/> | A: PBT <input type="checkbox"/> B: PA6T <input type="checkbox"/> C: PA9T <input type="checkbox"/> D: PA66 <input type="checkbox"/> E: PA46 <input type="checkbox"/> F: LCP <input type="checkbox"/> G: _____ <input type="checkbox"/> |
| Ordering:(N) 2 X <input type="checkbox"/> | | |

Ordering Dimensions

| A | B | C | D | H | W |
|----|----|----|----|----|---|
| PA | PB | PC | PD | PW | L |

Remarks:

| DIM"A" | PART NO |
|--------|------------------|
| 3.10 | DIP4-XX232XXAYX1 |
| 1.90 | DIP4-XX232XXAYX2 |

UNLESS OTHERWISE STATED
 DIMENSIONS IN mm
 TOLERANCE:

| | |
|--------|-------|
| LINEAR | X 0.5 |
| X.X | ±0.2 |
| X.XX | ±0.1 |

ANGLEAR ±1°

ORIGINALLY BY
 DRAWN: FHY
 CHECKED: FY
 APPROVED: FY
 DATE: 2020.12.19



深圳市征华电子有限公司
 Shenzhen ZWON Electronics Co.,Ltd.

Drawing No. DRXXX-XX

Scale: FIT
 Revision: A
 Sheet: 1 of 1

SERIES: IDC1.27*2.54*3.2/Two-piece

TYPICAL: 1.27x2.54mm IDC 塑高3.2 DIP
 MODEL: 两件式

Customer P/N: